

ADAM-4520A

Robust RS-232 to RS-422/485 Isolated Converter

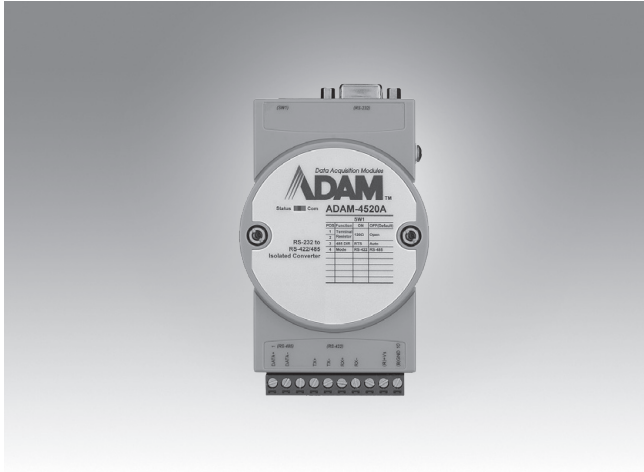

FCC CE RoHS COMPLIANT PRODUCT

Features

- Convert RS-232 to RS-422/485 signals
- Extend RS-232 data signals up to 1.2 km
- Data rate: 115.2 kbps
- 3000 VDC isolation
- Auto detection on baud rate / data format
- DIP switch selectable RS-422 or RS-485
- Build-in 120 ohm termination resistors (selectable)
- Power requirement +10 to +48 VDC
- Operating Temperature -40 ~ 85° C (-40 ~ 185° F)

Specifications

General

- **Connectors** 1 x plug-in terminal block (#14 ~ 22 AWG) (RS-422/485)
1 x DB9-F (RS-232)
- **Isolation Voltage** 3,000 V_{DC}
- **Power Consumption** Typical: 0.6 W @ 24 V_{DC}
Max.: 0.8 W @ 24 V_{DC}

Serial Communications

- **Input** RS-232 (DB9)
- **Output** RS-485 (2-wire) or RS-422 (4-wire)
- **Baudrate** 115.2 kbps, max. (RTS control and RS-422 mode switchable)

Common Specifications

General

- **Power Input** Unregulated 10 ~ 48 V_{DC} w/ power reversal protection
- **Dimensions** 102 x 60 x 27 mm

Environment

- **Operating Humidity** 5 ~ 95% RH
- **Operating Temperature** -40 ~ 85° C (-40 ~ 185° F)
- **Storage Temperature** -40 ~ 85° C (-40 ~ 185° F)

Ordering Information

- **ADAM-4520A-A** Robust RS-232 to RS-422/485 Isolated Converter

Dimensions

Unit: mm

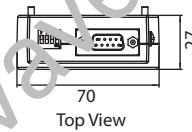

Top View

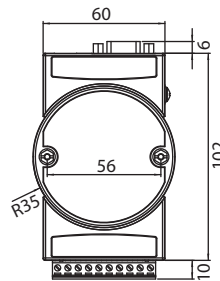

Front View



Side View

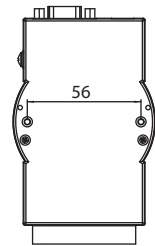

Rear View

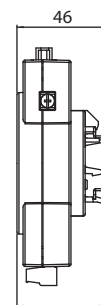

DIN Rail Mounting Adaptor